

In-Band Duplexer

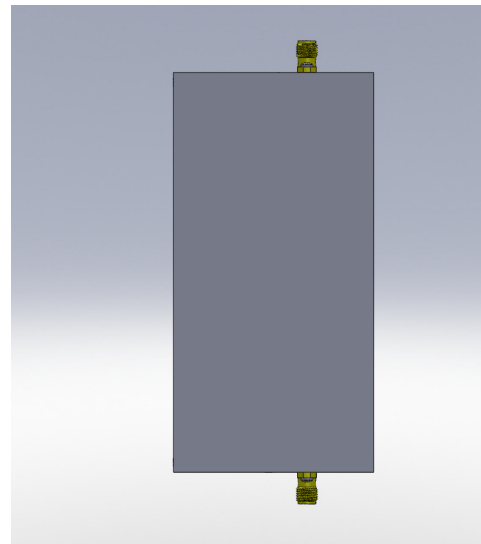
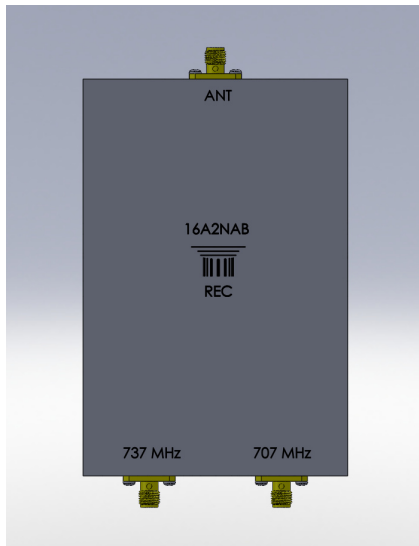

Renaissance Electronics has designed an in-band duplexer for LTE cell site applications. In a very compact footprint of 4.75" x 3.15", the duplexer provides 30 dB of rejection between the Tx and Rx. The insertion loss is less than 1 dB which is one of the critical specifications for optimum transmit and receive performance of the system. This duplexer can handle 10W CW and operate between temperature range of -20 to +70 C.